

## Data Sheet

### 23DDG MiniGauge

#### FEATURES

- Case/socket enclosure prevents dust, water, and corrosion
- Direct Dive Technology for excellent shock resistance
- Silicone-dampened coil (option) resists vibration effects

#### TYPICAL USES

- Air inflators/compressors
- Mini FRL's
- Pneumatic stack valves
- Medical/dental equipment
- Specialized OEM equipment



**23DDG**  
0.906" (23 mm) dial size



#### SPECIFICATIONS

Accuracy:	±5% of span
Size:	0.906" (23 mm)
Repeatability:	Better than 1%
Range:	180° arc: 60 - 100 psi 235° arc: 160 - 300 psi
Process Connection Location:	Back
Process Connection Size:	1/8 NPT
Dial:	Black figures on white background, aluminum
Pointer:	Brass, painted black
Dampening options:	Silicone dampened tube

#### WETTED COMPONENTS

Coil	Process Connection
Beryllium copper	Brass

#### NON-WETTED COMPONENTS

Case	Window
ABS blend (black)	Polycarbonate

#### MIN/MAX TEMPERATURE LIMITS

Version	Ambient	Process	Storage
23DDG	-40°F to 150°F (-40°C to 65°C)	-40°F to 150°F (-40°C to 65°C)	-40°F to 150°F (-40°C to 65°C)

#### KEY BENEFITS

- High impact-resistant polycarbonate window
- Reliability under rugged operating conditions
- ABS case material that is enduring and attractive
- Easy installations using wrench flats
- Cost effective solution
- Customizable dials
- No gears or bearing to wear out

# Data Sheet

## 23DDG MiniGauge

ORDERING CODE	Example:	23DDG	01	B	100	S50	XT5
<b>Model/Dial Size</b>							
23DDG - 0.906- inch (23mm) Black, ABS blend case		23DDG					
<b>Process Connection Size</b>							
01 - 1/8 NPT Male			01				
KG - 1/8 BSPT; R 1/8 84-PT 1/8							
<b>Process Connection Location</b>							
B - Back				B			
<b>Range (coding example only, see range table below for all standard ranges)</b>							
<b>Single Scale</b>							
100 - 100 psi					100		
<b>Setpoint</b>							
S50 - 50 psi						S50	
<b>Options (If choosing an option(s) must include an "X")</b>							
T5 - Throttle plug 0.013"							X__
T7 - Throttle plug 0.020"							T5
T9 - Throttle plug 0.063"							
SF - Silicone dampened tube for vibration							
RS - RoHS (EN directives 2011/65/EN and 2015/863)							

### RANGE TABLE

RANGE	RANGE CODE
0/60psi	60S30
0/100psi	100S50
0/160psi	160S80
0/200psi	200S100
0/300psi	300S150

### DIMENSIONS in [ ] are millimeters

For reference only, consult Ashcroft for specific dimensional drawings

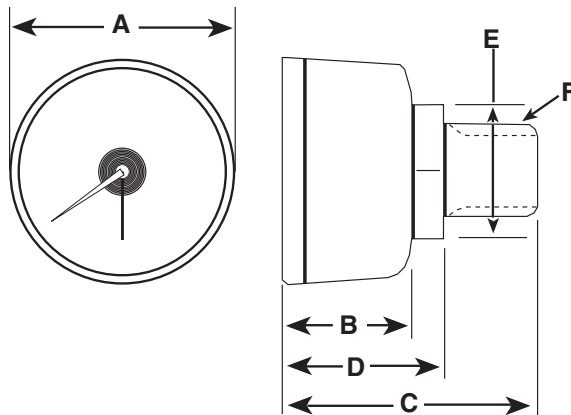

Dial Size Inches	Back Connection						Weight oz / kg
	A	B	C	D	E	F	
<b>0.906"</b> [23]	0.90 [23]	0.55 [14]	1.07 [27]	0.67 [17]	0.56 [15]	1/8 NPT	0.564 oz 0.016 kg