

## Data Sheet

### 23DDG MiniGauge

#### FEATURES

- 
- 
- 

#### TYPICAL USES

- 
- 
- 
- 
- 



**23DDG**  
0.906" (23 mm) dial size



#### SPECIFICATIONS

|                              |   |
|------------------------------|---|
| Accuracy:                    | ±5% of span at setpoint                           |
| Size:                        | 0.906" (23 mm)                                    |
| Repeatability:               | Better than 1%                                    |
| Range:                       | 180° arc: 60 - 100 psi<br>235° arc: 160 - 300 psi |
| Process Connection Location: | Back  |
| Process Connection Size:     | 1/8 NPT   |
| Dial:                        | Black figures on white background, aluminum       |
| Pointer:                     | Brass, painted black                              |
| Dampening options:           | Silicone dampened tube                            |

#### WETTED COMPONENTS

|                  |                    |
|------------------|--------------------|
| Coil             | Process Connection |
| Beryllium copper | Brass              |

#### NON-WETTED COMPONENTS

|                   |               |
|-------------------|---------------|
| Case              | Window        |
| ABS blend (black) | Polycarbonate |

#### MIN/MAX TEMPERATURE LIMITS

| Version | Ambient                           | Process                           | Storage                           |
|---------|-----------------------------------|-----------------------------------|-----------------------------------|
| 23DDG   | -40°F to 150°F<br>(-40°C to 65°C) | -40°F to 150°F<br>(-40°C to 65°C) | -40°F to 150°F<br>(-40°C to 65°C) |

#### KEY BENEFITS

- High impact-resistant polycarbonate window
- Reliability under rugged operating conditions
- ABS case material that is enduring and attractive
- Easy installations using wrench flats
- Cost effective solution
- Customizable dials
- No gears or bearing to wear out

# Data Sheet

## 23DDG MiniGauge

| ORDERING CODE   | Example: | 23DDG | 01 | B | 100 | S50 | XT5 |
|---|----------|-------|----|---|-----|-----|-----|
| <b>Model/Dial Size</b>  |          |       |    |   |     |     |     |
| 23DDG - 0.906- inch (23mm) Black, ABS blend case                                  |          | 23DDG |    |   |     |     |     |
| <b>Process Connection Size</b>  |          |       |    |   |     |     |     |
| 01 - 1/8 NPT Male   |          |       | 01 |   |     |     |     |
| KG - 1/8 BSPT; R 1/8 84-PT 1/8  |          |       |    |   |     |     |     |
| <b>Process Connection Location</b>  |          |       |    |   |     |     |     |
| B - Back  |          |       |    | B |     |     |     |
| <b>Range (coding example only, see range table below for all standard ranges)</b> |          |       |    |   |     |     |     |
| <b>Single Scale</b>   |          |       |    |   |     |     |     |
| 100 - 100 psi   |          |       |    |   | 100 |     |     |
| <b>Setpoint</b>   |          |       |    |   |     |     |     |
| S50 - 50 psi  |          |       |    |   |     | S50 |     |
| <b>Options (If choosing an option(s) must include an "X")</b>                     |          |       |    |   |     |     |     |
| T5 - Throttle plug 0.013"   |          |       |    |   |     |     | X__ |
| T7 - Throttle plug 0.020"   |          |       |    |   |     |     | T5  |
| T9 - Throttle plug 0.063"   |          |       |    |   |     |     |     |
| SF - Silicone dampened tube for vibration   |          |       |    |   |     |     |     |
| RS - RoHS (EN directives 2011/65/EN and 2015/863)                                 |          |       |    |   |     |     |     |

### RANGE TABLE

| RANGE    | RANGE CODE |
|----------|------------|
| 0/60psi  | 60S30      |
| 0/100psi | 100S50     |
| 0/160psi | 160S80     |
| 0/200psi | 200S100    |
| 0/300psi | 300S150    |

### DIMENSIONS in [ ] are millimeters

For reference only, consult Ashcroft for specific dimensional drawings

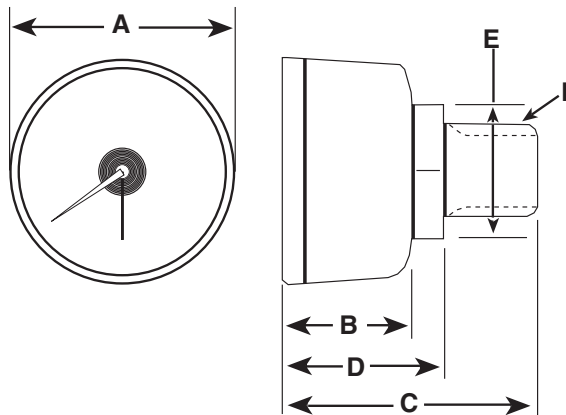

| Back Connection       |              |              |              |              |              |         | Weight<br>oz / kg    |
|-----------------------|--------------|--------------|--------------|--------------|--------------|---------|----------------------|
| Dial Size<br>Inches   | A            | B            | C            | D            | E            | F       |                      |
| <b>0.906"</b><br>[23] | 0.90<br>[23] | 0.55<br>[14] | 1.07<br>[27] | 0.67<br>[17] | 0.56<br>[15] | 1/8 NPT | 0.564 oz<br>0.016 kg |