

Instrument Fitting

Type 1037 – 1/2", 3/4", 1", 1 1/2", 2"

Case Type 1037

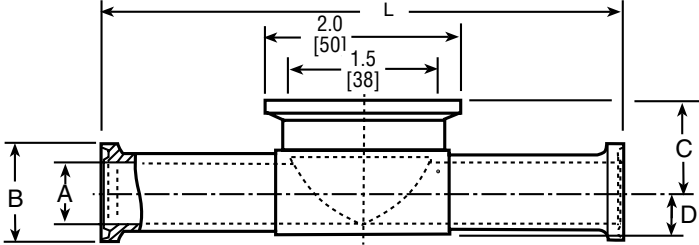

Inch/mm	A	B	C	D	L
1/2"	.38	.98	.81	.31	5.25
50	(9.6)	(24.9)	(20.6)	(7.9)	(133.4)
3/4"	.63	.98	.93	.43	5.25
75	(15.9)	(24.9)	(23.6)	(10.9)	(133.4)
1"	.87	1.98	1.05	.55	4.75
10	(22.1)	(50.4)	(26.7)	(14.1)	(120.7)
1 1/2"	1.37	1.98	1.31	.81	5.50
15	(34.7)	(50.4)	(33.3)	(20.6)	(139.7)
2"	1.86	2.51	1.56	(1.06)	(7.00)
20	(47.2)	(62.8)	(39.6)	26.9)	177.8)